

ENGAUGE SAFETY Hypodermic Needles and Syringes

Terumo's New Hinged Safety Hypodermic Needles and Syringes, ENGAUGE SAFETY is an economical* option with 3 ways to activate:

- Thumb • Finger • Hard surface

Clinicians can choose how they activate the safety mechanism depending on the clinical situation. The one-handed 3 modes of activation helps minimize the risk of needlestick injuries.



ENGAUGE SAFETY Hypodermic Needle

Packaging: 100/box, 8 boxes/case (800)

Product Code	Description
■ SENG-1825R	18G x 1" needle
■ SENG-1838R	18G x 1 ½" needle
■ SENG-2238R	22G x 1 ½" needle
■ SENG-2325R	23G x 1" needle
■ SENG-2338R	23G x 1 ½" needle
■ SENG-2516R	25G x 5/8" needle
■ SENG-2525R	25G x 1" needle
■ SENG-2538R	25G x 1 ½" needle
■ SENG-2713R	27G x 1 ½" needle
■ SENG-3013R	30G x 1 ½" needle

ENGAUGE 1cc Hypodermic Syringe

Packaging: 100/box, 36 boxes/case (3,600)

Low Dead Space Product Code	Description
SENG-SS-01L	1cc Luer Lock Syringe

ENGAUGE SAFETY Hypodermic Syringes with Safety Needle

Packaging: 100/box, 12 boxes/case (1,200)

Low Dead Space Product Code	Description
■ SENG-01L2516R	1cc Luer Lock Syringe with 25G x 5/8" needle
■ SENG-01L2525R	1cc Luer Lock Syringe with 25G x 1" needle
■ SENG-01L2713R	1cc Luer Lock Syringe with 27G x 1 ½" needle

ENGAUGE SAFETY Hypodermic Syringes with Safety Needle

Packaging: 100/box, 12 boxes/case (1,200)

Product Code	Description
■ SENG-03L2325R	3cc Luer Lock Syringe with 23G x 1" needle
■ SENG-03L2516R	3cc Luer Lock Syringe with 25G x 5/8" needle
■ SENG-03L2525R	3cc Luer Lock Syringe with 25G x 1" needle
■ SENG-03L2538R	3cc Luer Lock Syringe with 25G x 1 ½" needle

Call your Terumo representative at:
1.800.888.3786 or visit www.TerumoTMP.com
 and click on Find Your Local Terumo Representative

Featuring 1cc Low Dead Space

*Data on file.
 These products have no components made of natural rubber latex.

ENGAUGE Safety Hypodermic Needle: Instructions For Use

The TERUMO® ENGAUGE SAFETY HYPODERMIC NEEDLES are intended to be used with a luer slip or luer lock syringe for aspiration and injection of fluids for medical purpose. After withdrawal of the needle from the body, the attached needle safety shield can be manually activated to cover the needle immediately after use to minimize risk of accidental needlestick.

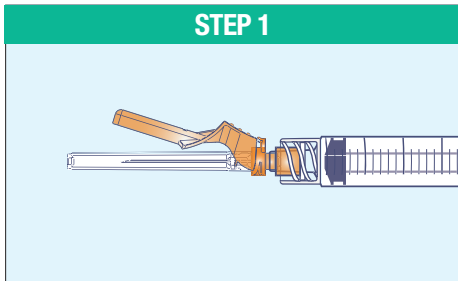

1. Carefully remove the safety needle from the package. Then securely attach the safety needle to a syringe with a push and clockwise twist motion.

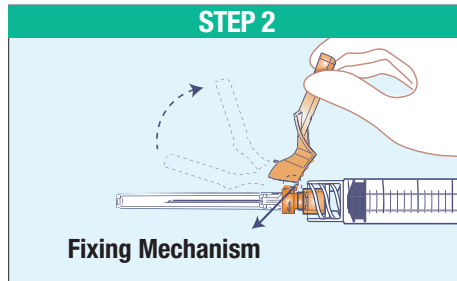

2. Move the safety sheath away from the needle and toward the syringe barrel to the angle shown, prior to removing the protection cap. The fixing mechanism will keep the safety sheath in the position you set.

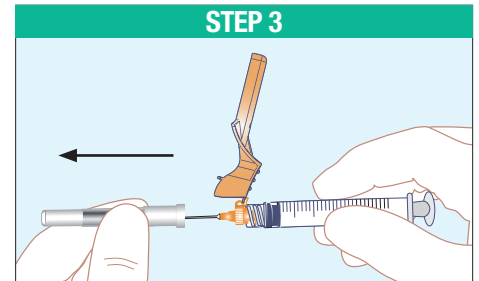

3. Remove the protection cap carefully to avoid damaging the needle. Perform injection procedure according to established techniques.

After the injection procedure, the safety mechanism could be activated by any of the three methods given below, i.e. 4a, 4b and 4c.

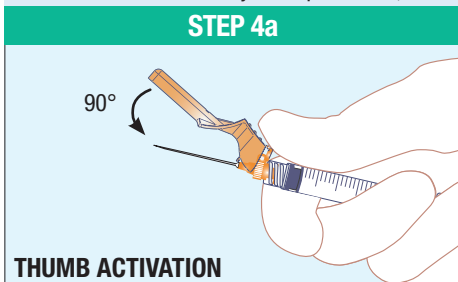

STEP 4a. Using a one-handed technique, push the tab forward with your thumb so that the sheath is less than 90 degrees from the needle. Then push down with a firm, quick motion until a distinct audible click is heard.

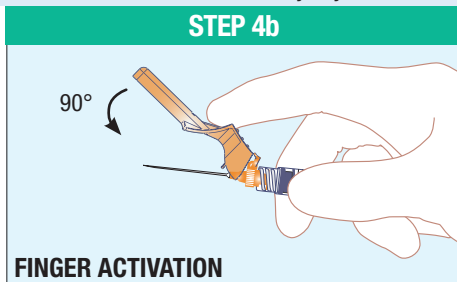

STEP 4b. Using a one-handed technique, push the tab forward with your finger so that the sheath is less than 90 degrees from the needle. Then push down with a firm, quick motion until a distinct audible click is heard.

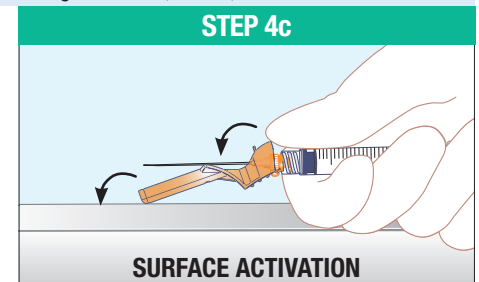

STEP 4c. Using a one-handed technique, push the tab forward with your finger or thumb so that the sheath is less than 90 degrees from the needle. Position the sheath in the direction of activation at a lowest possible angle to the flat surface. Then push down with a firm, quick motion until a distinct audible click is heard.

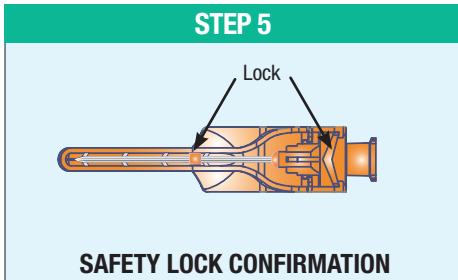

STEP 5. Visually confirm that the needle is fully engaged under the lock. Dispose of used needles and materials following the policies and procedures of your facility as well as your federal and local regulations for sharps disposal.

Note: The location of the lock will vary depending upon needle size. Audible click may not be heard on small needle sizes; visual confirmation is required.

WARNINGS

- Visually inspect and carefully check the device and packaging before use. Improper transport and handling may cause structural and/or functional damage to device or packaging.
- Use once and discard immediately in accordance with local safety standards.
- Do not replace original needle cover after use.
- Handle with care to avoid needle sticks.
- Re-use of single-use device creates a potential risk to patient or user. It may lead to contamination and/or impairment of functional capability. Contamination and/or limited functionality of the device may lead to injury, illness or death of the patient.

CAUTION

- Safety Needle is guaranteed non-toxic, sterile and non-pyrogenic if the individual package has not been opened or damaged.
- Do not attempt to deactivate the safety device by forcing the needle out of the safety sheath.
- For single use only. Do not reuse.
- Do not clean or re-sterilize.
- Safety Needle must not be reprocessed.
- If needle is bent or damaged, no attempt should be made to straighten needle or use the product.

PRECAUTIONS

- Safety Needle should be used according to these instructions for use.
- Do not use if the individual package is damaged or opened.
- The product should be used immediately after opening of the package.
- Keep hands behind needle at all times during use and disposal.
- Store in a cool and dry place.
- Do not expose to heat or direct sunlight.
- Observe Universal Precautions on ALL patients.

RX ONLY. The advertisement is directed to physicians only, and not to consumers. Refer to product labels and packaging insert for complete warnings, precautions, potential complications, and instructions for use.



TERUMO MEDICAL CORPORATION 265 Davidson Avenue Somerset NJ 08873 U.S.A.

TERUMO and TERUMO are trademarks owned by Terumo Corporation, Tokyo, Japan, and they are registered with the U.S. Patent & Trademark Office. All rights reserved. All brand names are trademarks or registered trademarks of their respective owners. PM-07186