

Quality time for better care



Product Catalog (US)

Conventional Needles • Micro-Collection Products
Safety Products • Winged Infusion Sets • I.V. Catheters

Table of Contents

Hypodermics

SurGuard®3 Safety Hypodermic Needles and Syringes	3-4
ENGAUGE SAFETY Hypodermic Needles and Syringes	5
Terumo Conventional Hypodermic Needles	6
1cc Tuberculin Luer Slip Syringes	6
3cc Syringes with Needle for Filling	6
Syringes without Needle	7

Micro-Collection

Surshield® Safety Blood Collection Sets	8
Multi-Sample Luer Adapter	8
Capiject® Safety Lancets	9

Winged Infusion Needle Sets

Surshield® Safety Winged Infusion Sets	10
SURFLO® Winged Infusion Sets	10

I.V. Catheters

SURFLO® ETFE I.V. Catheters	11
SurFlash® Polyurethane I.V. Catheters	12

Frequently Asked Questions and Technical Support

13

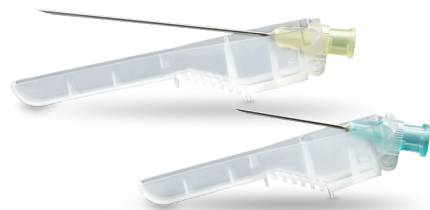

Pick how you click.

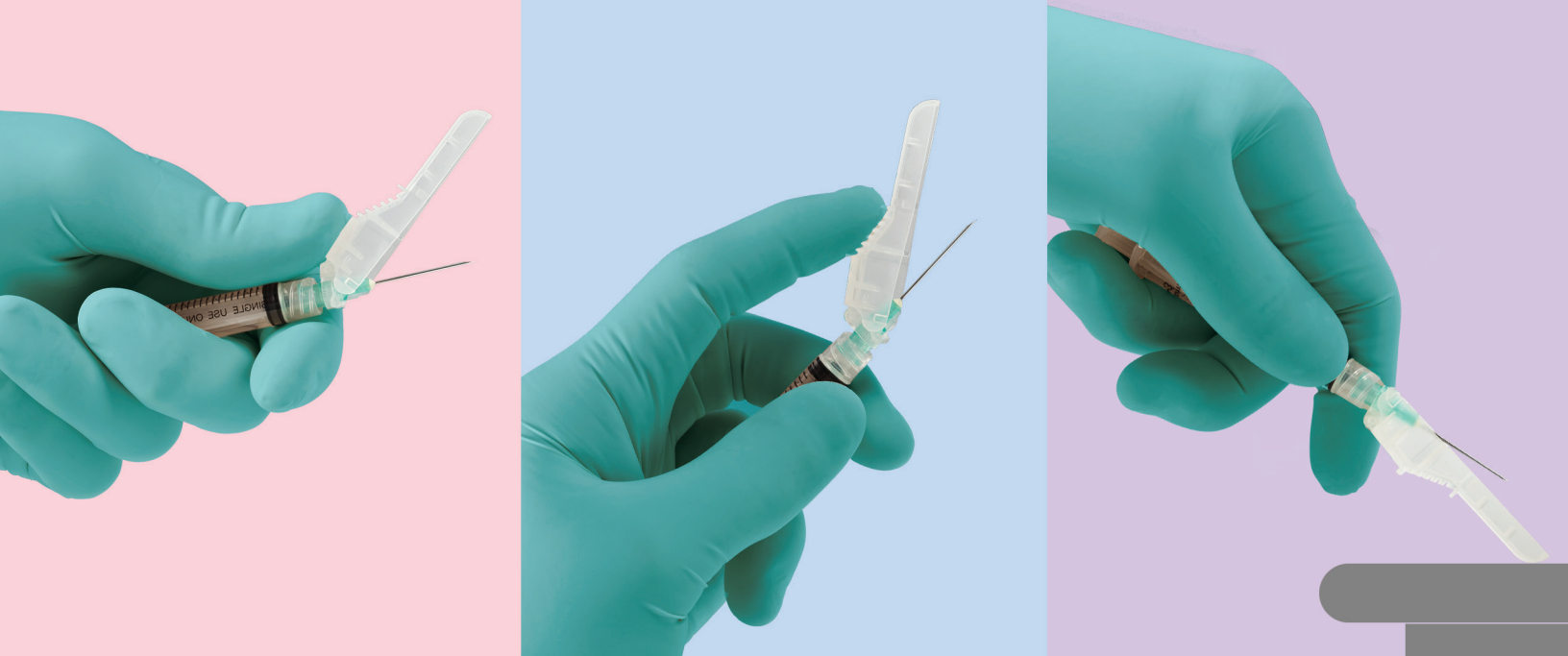

With 3 ways to activate and a broader range of sizes than most other brands, SurGuard®3 is the industry's most adaptable safety needle. Add separate thumb and finger grips, sharper needles, and competitive pricing, and you'll understand why we say SurGuard®3 is the one needle that fits *every* clinician's style.

- 3 modes of activation—thumb, finger, or hard surface
- Separate finger and thumb grips with ridges and nonslip surfaces
- Hub and needle locks for security post activation
- Broad range of sizes
- Firm injection feel
- Sharpest needles among major brands tested*
 - 10% sharper than similar needles from Becton, Dickinson and Company
 - More comfortable injections for patients

Bottom line: No matter what you're looking for in a needle, you're looking for SurGuard®3.

SurGuard® 3 Safety Hypodermic Needles and Syringes

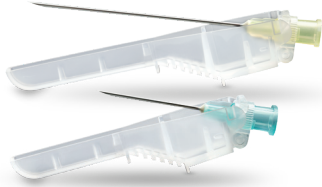

SurGuard® 3 Safety Hypodermic Needles

Packed: 100/box, 8 boxes/case (800)

Product Code	Description
SG3-1825	18G x 1" needle
SG3-1838	18G x 1 1/2" needle
SG3-2025	20G x 1" needle
SG3-2038	20G x 1 1/2" needle
SG3-2051	20G x 2" needle
SG3-2125	21G x 1" needle
SG3-2138	21G x 1 1/2" needle
SG3-2225	22G x 1" needle
SG3-2238	22G x 1 1/2" needle
SG3-2325	23G x 1" needle
SG3-2338	23G x 1 1/2" needle
SG3-2516	25G x 5/8" needle
SG3-2525	25G x 1" needle
SG3-2538	25G x 1 1/2" needle
SG3-2713	27G x 1/2" needle
SG3-3013	30G x 1/2" needle

SurGuard® 3 Hypodermic Syringes with Safety Needle

Packed: 100/box, 4 boxes/case (400)

Product Code	Description
SG3-01T2516	1CC Syringe with 25G x 5/8" needle
SG3-01T2713	1CC Syringe with 27G x 1/2" needle
SG3-03L2025	3CC Syringe with 20G x 1" needle
SG3-03L2038	3CC Syringe with 20G x 1 1/2" needle
SG3-03L2125	3CC Syringe with 21G x 1" needle
SG3-03L2138	3CC Syringe with 21G x 1 1/2" needle
SG3-03L2225	3CC Syringe with 22G x 1" needle
SG3-03L2238	3CC Syringe with 22G x 1 1/2" needle
SG3-03L2325	3CC Syringe with 23G x 1" needle
SG3-03L2516	3CC Syringe with 25G x 5/8" needle
SG3-03L2525	3CC Syringe with 25G x 1" needle

*Data on file.

These products have no components made of natural rubber latex.

ENGAUGE SAFETY Hypodermic Needles and Syringes

Terumo's New Hinged Safety Hypodermic Needles and Syringes, **ENGAUGE SAFETY** is an economical* option with 3 ways to activate:

- Thumb • Finger • Hard surface



ENGAUGE SAFETY Hypodermic Needle

Packaging: 100/box, 8 boxes/case (800)

Product Code	Description
■ SENG-1825R	18G x 1" needle
■ SENG-1838R	18G x 1 1/2" needle
■ SENG-2238R	22G x 1 1/2" needle
■ SENG-2325R	23G x 1" needle
■ SENG-2338R	23G x 1 1/2" needle
■ SENG-2516R	25G x 5/8" needle
■ SENG-2525R	25G x 1" needle
■ SENG-2538R	25G x 1 1/2" needle
■ SENG-2713R	27G x 1/2" needle
■ SENG-3013R	30G x 1/2" needle

ENGAUGE SAFETY Hypodermic Syringes with Safety Needle

Packaging: 100/box, 12 boxes/case (1,200)

Low Dead Space

Product Code	Description
■ SENG-01L2516R	1cc Luer Lock Syringe with 25G x 5/8" needle
■ SENG-01L2525R	1cc Luer Lock Syringe with 25G x 1" needle
■ SENG-01L2713R	1cc Luer Lock Syringe with 27G x 1/2" needle

ENGAUGE SAFETY Hypodermic Syringes with Safety Needle

Packaging: 100/box, 12 boxes/case (1,200)

Product Code	Description
■ SENG-03L2325R	3cc Luer Lock Syringe with 23G x 1" needle
■ SENG-03L2516R	3cc Luer Lock Syringe with 25G x 5/8" needle
■ SENG-03L2525R	3cc Luer Lock Syringe with 25G x 1" needle
■ SENG-03L2538R	3cc Luer Lock Syringe with 25G x 1 1/2" needle



ENGAUGE 1cc Hypodermic Syringe

Packaging: 100/box, 36 boxes/case (3,600)

Low Dead Space

Product Code	Description
SENG-SS-01L	1cc Luer Lock Syringe

*Data on file.

These products have no components made of natural rubber latex.

Conventional Hypodermic Needles and Syringes

Our double-bevel design is precision-ground and honed to exacting quality standards. This attention to detail enables Terumo needles to penetrate skin with less force, which can mean greater comfort for patients.

Terumo® Conventional Hypodermic Needles

Packed: 100/box, 10 boxes/case (1,000)

Product Code	Description
■ NN2713R	27G x 1/2" needle
■ NN2732R	27G x 1 1/4" needle
■ NN3013R	30G x 1/2" needle
■ NN3025R	30G x 1" needle



All Competitors

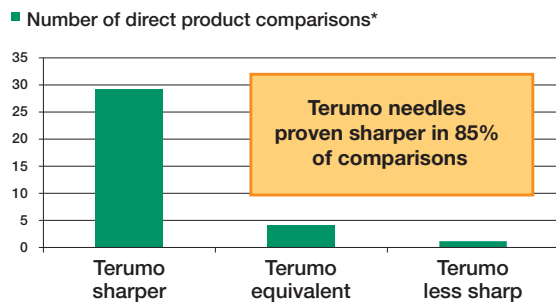

* In Independent laboratory testing, Terumo needles were shown, on average, to be the sharpest among brands tested:

10% sharper than BD (22G - 30G)

16% sharper than Covidien (22G - 27G)



1CC Tuberculin Luer Slip Syringes

Packed: 100/box, 10 boxes/case (1,000)

Graduations: 0.01cc (1cc total)

Product Code	Description
SS-01T	1cc TB syringe without needle, luer slip
SS-01T2516	1cc TB syringe with 25G x 5/8" removable needle
SS-01T2609	1cc TB syringe with 26G x 3/8" removable needle
SS-01T2713	1cc TB syringe with 27G x 1/2" removable needle

3CC Syringes with Needle for Filling

Packed: 100/box, 10 boxes/case (1,000)

Style: Luer Lock Tip

Graduations: 0.1cc (3cc total)

Product Code	Description
SS-03L2138	3cc syringe with 21G x 1 1/2" needle



*Data on file. These products have no components made of natural rubber latex.

Hypodermic Syringes

The plastic blister package is tamper evident for assurance of sterility. The peel-packs provide waste disposal cost savings versus the bulky plastic tube containers of some other syringes. Perhaps most importantly, Terumo syringes with needles offer maximum patient comfort delivered through ultimate sharpness and smoothness.



Luer Lock Tip



Eccentric Luer Tip



Catheter Tip

3CC Syringes

Packed: 100/box, 10 boxes/case (1,000)
Graduations: 0.1cc (3cc total)

Product Code	Description
	Without Needles:
SS-03L	Luer Lock Tip

20CC Syringes

Packed: 50/box, 4 boxes/case (200)
Graduations: 1cc (25cc total)

Product Code	Description
	Without Needles:
SS-20L2	Luer Lock Tip

5CC Syringes

Packed: 100/box, 6 boxes/case (600)
Graduations: 0.2cc (6cc total)

Product Code	Description
	Without Needles:
SS-05L	Luer Lock Tip

30CC Syringes

Packed: 25/box, 8 boxes/case (200)
Graduations: 1cc (35cc total)

Product Code	Description
	Without Needles:
SS-30L	Luer Lock Tip

10CC Syringes

Packed: 100/box, 6 boxes/case (600)
Graduations: 0.2cc (12cc total)

Product Code	Description
	Without Needles:
SS-10L	Luer Lock Tip

60CC Syringes

Packed: 25/box, 4 boxes/case (100)
Graduations: 1cc (60cc total)

Product Code	Description
	Without Needles:
SS-60L	Luer Lock Tip
SS-60ES	Eccentric Luer Tip
SS-60C	2 oz. Catheter Tip

These products have no components made of natural rubber latex.

Surshield® Safety Winged Blood Collection Sets

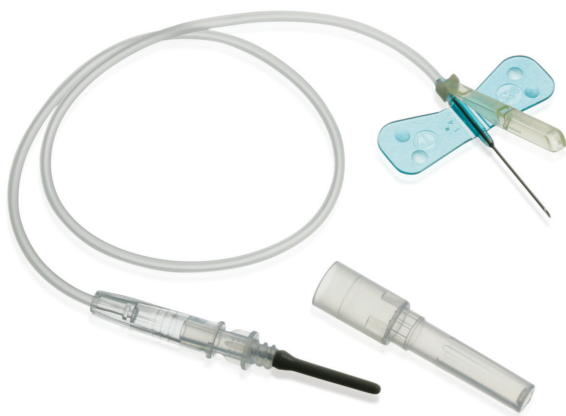

12" Tubing

Packed: 50/box, 10 boxes/case (500)

Product Code	Description
MN*SVS21B30	21G x 3/4" needle
MN*SVS23B30	23G x 3/4" needle
MN*SVS25B30	25G x 3/4" needle



7" Tubing

Packed: 50/box, 10 boxes/case (500)

Product Code	Description
MN*SVS21B18	21G x 3/4" needle
MN*SVS23B18	23G x 3/4" needle

Multi-Sample Luer Adapter



Sterile and disposable, adapters fit into standard infusion sets transforming them into winged blood collection sets. This allows multiple draws into evacuated tubes. Accepts standard tube holders.

Packed: 100/box, 30 boxes/case (3,000)

Product Code	Description
XX*MN2000TE	VENOJECT® Multi-Sample Luer Adapter (male).

These products have no components made of natural rubber latex.

Terumo's Surshield Safety Winged Needle Sets with one-handed activation provides a solution with a cost-effective, easy to use design. Press shield over the needle until it locks into place.

- Unique needle locking mechanism helps reduce the risk of needlestick injuries
- One-handed activation for safety and ease of use
- No change in needle insertion technique
- Simple, built-in safety design is easy to use

1. Flip safety shield toward needle. Remove the needle and apply digital pressure to the site.

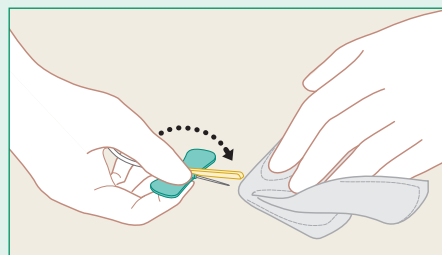

2. With the wing and shield between your thumb and index finger, press the safety shield against a hard surface such as a bedside table until an audible click is heard.

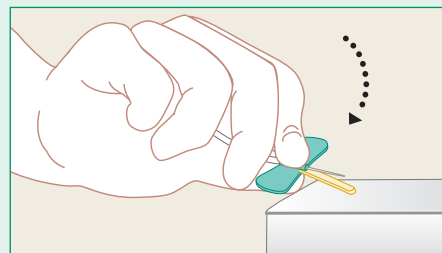

3. Visually confirm activation of the safety feature.



Refer to the product labels and package insert for complete warnings, precautions, potential complications, and instructions for use.

Capiject® Safety Lancets

High quality, single-use lancets offer the form, fit and function you've come to rely on

- Never see or handle the sharp:**
 Automatic blade or needle retraction styles - the sharp edge is enclosed before and after use
- No special staging required:**
 Ready to use right out of the box
- One-step activation:**
 Convenient activation for precise and consistent results
- Color-coded sizes:**
 Quick identification of the right product



Packed: 200/box, 10 boxes/case (2,000)

Product Code	Color	Description	Width/Gauge	Depth
200101	Pink	Blade	1.5mm	1.0mm
200102	Green	Blade	1.5mm	1.5mm
200103	Blue	Blade	1.5mm	2.0mm
200104	Orange	Needle	23G	2.25mm
200105	Purple	Needle	28G	1.25mm

These products have no components made of natural rubber latex.

Winged Infusion Sets

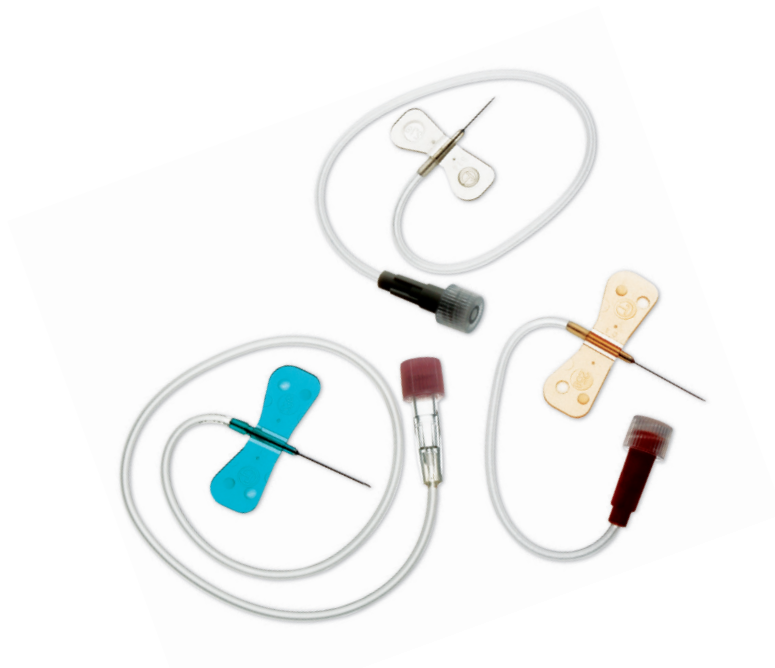
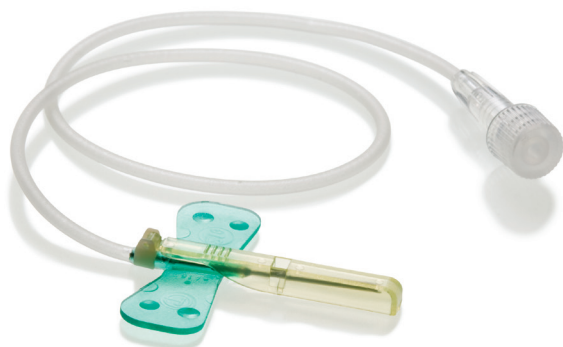

Surshield® Safety Winged Infusion Sets

12" Tubing

Packed: 50/box, 10 boxes/case (500)

Product Code	Description
SV*S19BL	19G x 3/4" needle
SV*S21BL	21G x 3/4" needle
SV*S23BL	23G x 3/4" needle
SV*S25BL	25G x 3/4" needle

3 1/2" Tubing

SV*S19BLS	19G x 3/4" needle
SV*S21BLS	21G x 3/4" needle
SV*S23BLS	23G x 3/4" needle
SV*S25BLS	25G x 3/4" needle

SURFLO® Winged Infusion Sets

12" Tubing

Packed: 50/box, 10 boxes/case (500)

Product Code	Description
SV-18BLK	18G x 3/4" needle
SV-19BLK	19G x 3/4" needle
SV-21BLK	21G x 3/4" needle
SV-22BLK	22G x 3/4" needle
SV-23BLK	23G x 3/4" needle
SV-25BLK	25G x 3/4" needle

8" Tubing

Packed: 100/box, 10 boxes/case (1,000)

Product Code	Description
SV*25EL	25G x 1/2" needle
SV*27EL	27G x 1/2" needle

3 1/2" Tubing

Packed: 100/box, 5 boxes/case (500)

Product Code	Description
SV*19BLS	19G x 3/4" needle
SV*21BLS	21G x 3/4" needle
SV*23BLS	23G x 3/4" needle
SV*25BLS	25G x 3/4" needle

These products have no components made of natural rubber latex.

SURFLO® ETFE I.V. Catheters

A sharp double-bevel introducer needle plus a medical grade lubricant allow for easier penetration and smoother travel through tissue. Preview chamber in clear sure-grip hub gives immediate indication of proper placement. Flexible thinwall catheter with large inner diameter assures good blood flow. All this plus safe, easy-to-handle, tamper-evident packaging make SURFLO® I.V. Catheters a great clinical value.



Packed: 50/box, 4 boxes/case (200)

Product Code	Description
■ SR-OX1451CA	14G x 2"
■ SR-OX1632CA	16G x 1 ¼"
■ SR-OX1651CA	16G x 2"
■ SR-OX1664CA	16G x 2 ½"
■ SR-OX1832CA	18G x 1 ¼"
■ SR-OX1851CA	18G x 2"
■ SR-OX1864CA	18G x 2 ½"
■ SR-OX2025CA	20G x 1"
■ SR-OX2032CA	20G x 1 ¼"
■ SR-OX2051CA	20G x 2"
■ SR-OX2225CA	22G x 1"
■ SR-OX2419CA	24G x ¾"

These products have no components made of natural rubber latex.

SurFlash® Polyurethane I.V. Catheters

With SurFlash®, visual confirmation of catheter placement occurs due to a unique flashback feature. Flashback appears between the specially grooved needle and the catheter, providing medical staff with a higher certainty of proper catheter placement. The specially grooved needle also improves the ability to visualize flashback in patients where venipuncture is more difficult, and because SurFlash® is made of polyurethane, which is firm at room temperature and softer at body temperatures, patient comfort is enhanced without compromising proper technique.

Packed: 50/box, 4 boxes/case (200)

Product Code	Description
SR*FF1451	14G x 2"
SR*FF1651	16G x 2"
SR*FF1664	16G x 2 ½"
SR*FF1832	18G x 1 ¼"
SR*FF1851	18G x 2"
SR*FF1864	18G x 2 ½"
SR*FF2025	20G x 1"
SR*FF2032	20G x 1 ¼"
SR*FF2051	20G x 2"
SR*FF2225	22G x 1"
SR*FF2419	24G x ¾"

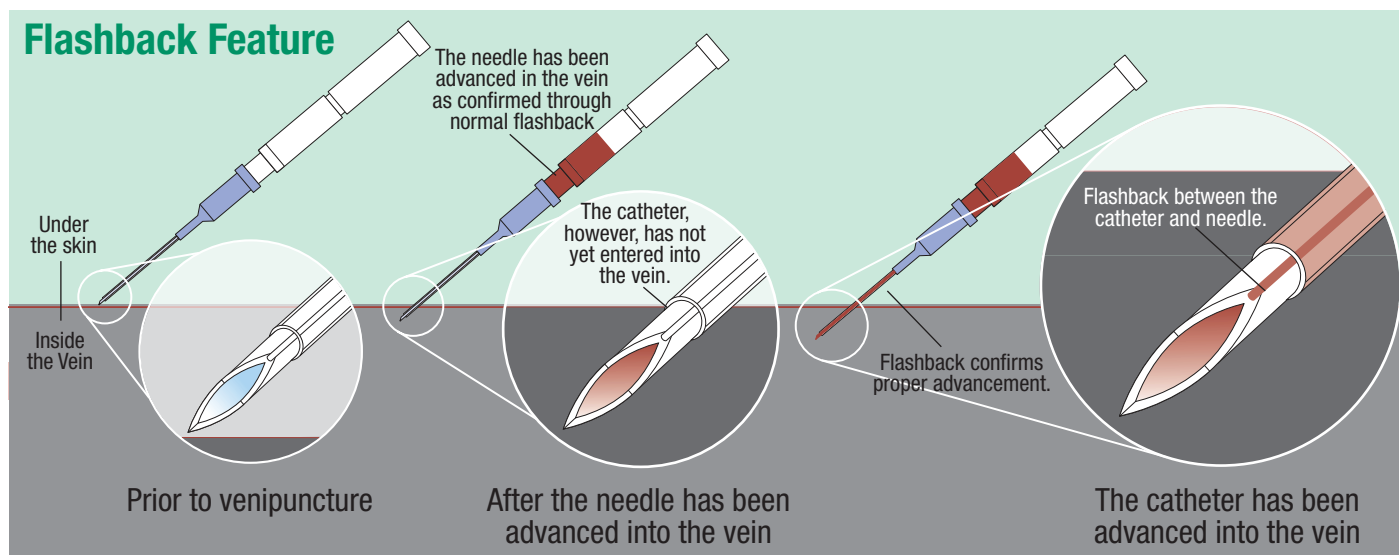

Note: The needle insertion angle in the illustration differs from actual insertion angle.

These products have no components made of natural rubber latex.

Frequently Asked Questions and Technical Support

■ How can I contact Terumo Medical Products?

Please visit our website, www.TerumoTMP.com, for more information or phone Customer Care at 1-800-888-3786

■ How can I obtain samples?

Please visit our website, www.TerumoTMP.com to request samples.

■ How can I order Terumo products through a distributor?

To find a distributor, please see Terumo website: www.TerumoTMP.com and click on Customer Support to find a List of Authorized Terumo distributors. Distributors should call Customer Administration for all questions related to orders and invoices: (800) 888-3786

■ How can I obtain pricing?

You must check with your local distributor for pricing since our business is conducted through authorized distributors.

■ Where are you located?

The Terumo Medical Corporate office is located at:
265 Davidson Avenue, Suite 320, Somerset, NJ 08873
1-800-283-7866
www.TerumoTMP.com

■ What is the shelf life of Terumo products?

Standard & Safety Syringes & Needles: 5 years
Standard I.V. Catheters: 3 years
Standard & Safety Blood Collection/Infusion: 3 years
Capject Lancets: 5 years

■ What's the difference between SurFlash® & SURFLO® I.V. Catheters?

SurFlash is an I.V. Polyurethane Catheter which allows for a visual confirmation of catheter placement due to its unique flashback feature. SURFLO is our regular ETFE I.V. Catheter. Both are radio-opaque and these products have no components made of natural rubber latex.

www.TerumoTMP.com

RX ONLY. The advertisement is directed to physicians only, and not to consumers. Refer to product labels and packaging insert for complete warnings, precautions, potential complications, and instructions for use. Products may not have regulatory approval in all countries. Please contact your local sales representative if you have questions about the availability of products in your area.



TERUMO and TERUMO are trademarks owned by Terumo Corporation, Tokyo, Japan, and they are registered with the U.S. Patent & Trademark Office. SURFLO, SURSHIELD, SURFLASH and VENOJECT are registered trademarks of Terumo Corporation, Tokyo, Japan and they are registered with the U.S. Patent & Trademark Office. CAPIJECT and SURGUARD are registered trademarks of Terumo Medical Corporation, Somerset, NJ. © 2023 Terumo Medical Corporation. All rights reserved. All brand names are trademarks or registered trademarks of their respective owners. Rev. 8/23 PM-07232

TERUMO MEDICAL CORPORATION 265 Davidson Avenue Somerset NJ 08873 U.S.A.